

Airbus Corporate Jets

**ACJ350XWB**



**ACJ350**X<sup>WB</sup>

The world's most  
modern VIP widebody

**ACJ350X<sup>WB</sup>**

Worldwide success

**Xtra range**

fly the world, non-stop

**Xtra comfort**

more space, less noise, less fatigue

**Xtra innovative technology**

finest state-of-the-art design







**ACJ350**X<sup>WB</sup>

Xtra range

# ACJ350<sup>XWB</sup>

## Ultimate range leader



from London

25 passengers  
85% annual  
reliability headwinds  
NBAA Flight Profile  
200nm Diversion  
distance  
Subject to Weight  
and balance analysis

**Over 22 flying hours**  
11,100nm



**ACJ350**X<sup>WB</sup>

Xtra comfort



# ACJ350<sup>XWB</sup>

## Ultimate comfort experience



ACJ350-900

270m<sup>2</sup> / 2,905 ft<sup>2</sup> cabin space



ACJ350-1000

308m<sup>2</sup> / 3,315 ft<sup>2</sup> cabin space

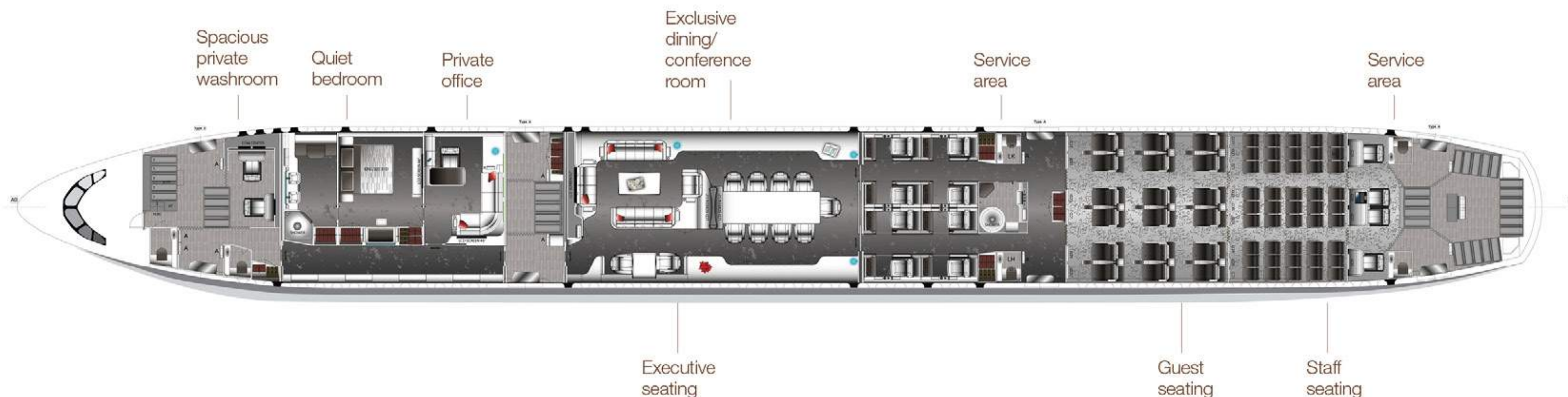

Xtra wide cabin brings you unmatched comfort to work and relax

Xtra space for Xtra comfort with full flexibility



**ACJ350X<sup>WB</sup>**

Ultimate comfort  
for your home in the sky

A cabin environment  
designed for ultimate comfort

- Cleanest air: all cabin air exchanged every 2 minutes
- Controlled temperature: 7 to 8 air conditioning zones
- Comfort: less fatigue because of lower cabin altitude (6,000ft at max flight level)
- Quietest sound-level in the industry





## ACJ350X<sup>WB</sup>

Ultimate level of space  
and well being

Ultimate level of well-being  
vs direct competition

- Space: more cabin space with **270m<sup>2</sup>** to **308m<sup>2</sup>**
- Noise: **4db SIL** quieter
- Luminosity: **6** more windows
- Air quality: **20%** more fresh air





**ACJ350**X<sup>WB</sup>

Xtra innovative  
technology



# ACJ350<sup>WB</sup>

Ultimate technology  
innovation by design



## New fuselage Most innovative fuselage

- > 53% composites
- > Intelligent airframe, with **up to 70%** new materials



### 4-panel cross section

Enables long fuselage sections  
Local thickness optimisation

Optimised for robustness  
and weight control



### 3 long sections

Simpler and more robust  
Fewer circular joints

- > Reduced maintenance cost
- > Maximum operational flexibility
- > Longer maintenance intervals

Ultimate efficiency  
unrivalled fuel efficiency and maintenance cost

**25% lower\***

- > Fuel burn
- > CO<sub>2</sub> Emissions
- > Cash operating cost



## New engines

Lowest specific fuel  
consumption and quieter  
operation



## New cockpit and systems

Building on innovations from  
the A380, it features modern,  
simplified systems and  
a common flight-deck



## New wing

Biomimicry Morphing wings  
Sustainable design

**99.2%**  
reliability

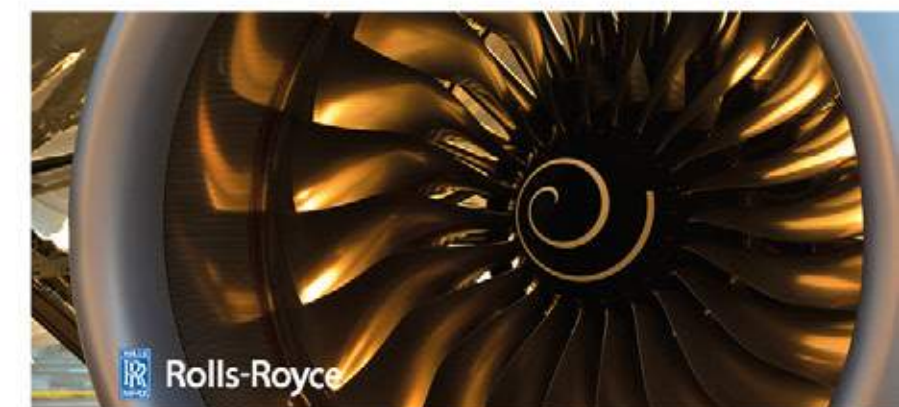

Powered by world's most efficient large aero-engines



Advanced protection - Full connectivity



Unique adaptative wing technology

\*compared with previous generation competing aircraft



# Easyfit

Outfitting solution providing  
Xtra peace of mind

- › No drilling concept
- › Less cost
- › Less time
- › Improved maintenance

The Easyfit  
package includes:

- › Pre-defined attachment points for VIP cabin installation in the carbon fibre fuselage
- › Specific avionics provisions for VIP cabin systems
- › Pre engineered concept developed with experienced cabin outfitters

**AMAC AEROSPACE**

**JETAVIATION**  
A GENERAL DYNAMICS COMPANY

**Lufthansa Technik**  
VIP & Special Mission Aircraft Services







**ACJ350**X<sup>WB</sup>

The world's most  
modern VIP widebody







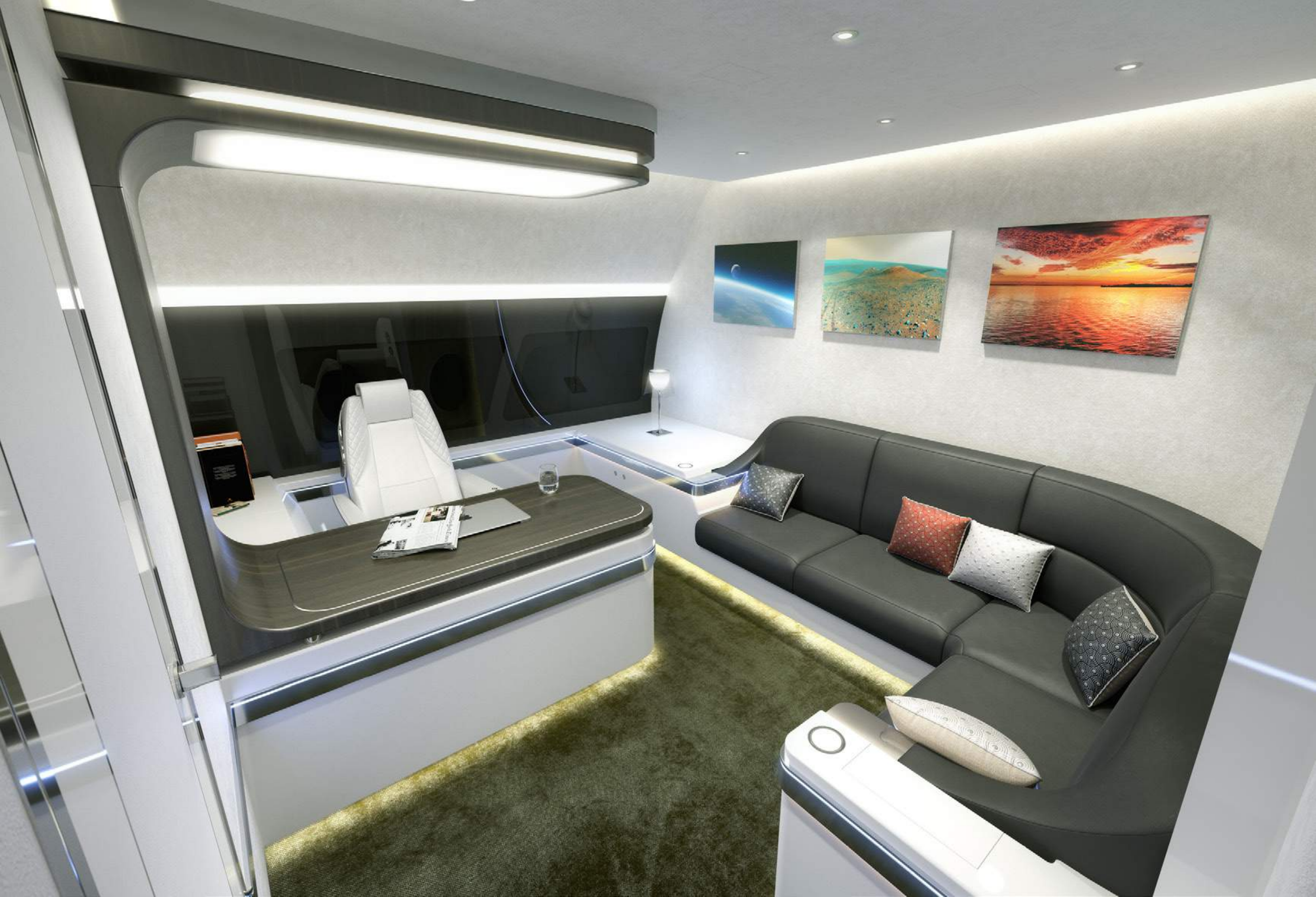









AMAC Aerospace  
Designer: UNIQUE AIRCRAFT  
Rendering specialist: ACA-3d  
Approved ACJ350 XWB outfitter





Jet Aviation:  
Designer: Jet Aviation Design Studio  
Rendering specialist : ACA-3d  
Approved ACJ350 XWB outfitter





Jet Aviation:  
Designer: Jet Aviation Design Studio  
Rendering specialist : ACA-3d  
Approved ACJ350 XWB outfitter







**ACJ350X<sup>WB</sup>**

Excellence  
in customer care



# Technical data

## ACJ350-900

### External dimensions

Length	66.8 m	219 ft 2 in
Height	17.05 m	55 ft 11 in
Fuselage width	5.96 m	19 ft 7 in
Wingspan	64.75 m	212 ft 5 in

### Cabin dimensions

Cabin length	51.04 m	167 ft 5 in
Max cabin width	5.61 m	18 ft 5 in
Cabin floor area	270 m²	2,905 ft²

### Basic weights

Maximum take-off weight	280 t	606,200 lb
Maximum landing weight	205 t	451,900 lb
Maximum zero fuel weight	192 t	423,300 lb
Maximum fuel capacity	165,000 lit	43,588 USG

### Engines / Speed / Max flight level

Rolls-Royce Trent XWB	2 x 84,000 lb
Typical Cruise Speed	M 0.85
Max flight level	43,000 ft

## ACJ350-1000

### External dimensions

Length	73.79 m	242 ft 1 in
Height	17.08 m	56 ft 0 in
Fuselage width	5.96 m	19 ft 7 in
Wingspan	64.75 m	212 ft 5 in

### Cabin dimensions

Cabin length	58.03 m	190 ft 5 in
Max cabin width	5.61 m	18 ft 5 in
Cabin floor area	308 m²	3,315 ft²

### Basic weights

Maximum take-off weight	316 t	696,200 lb
Maximum landing weight	236 t	520,300 lb
Maximum zero fuel weight	223 t	491,600 lb
Maximum fuel capacity	156,000 lit	41,210 USG

### Engines / Speed / Max flight level

Rolls-Royce Trent XWB	2 x 97,000 lb
Typical Cruise Speed	M 0.85
Max flight level	43,000 ft

### Toulouse, France:

Airbus Corporate Jets  
2 Rond-point Emile Dewoitine  
31700 Blagnac  
France  
E-mail: corporate.jet@airbus.com  
www.acj.airbus.com

### Beijing, P.R. China

Phone: +861080475288

Airbus (China) Enterprise Management  
and Services Co.Ltd  
Tian Zhu Lu 8, Building 2,  
Beijing Airport Economic Core Zone,  
Shunyi District,  
Beijing, 101312, P.R. China

### Dubai, UAE

Phone: +971 4 2996761  
Fax: +971 4 2996762

Airbus Middle East  
Dubai Airport Freezone  
East Wing 2, Mezzanine Floor,  
PO BOX 54341 Dubai

### Hong Kong, China

Phone: +852 2340 2330  
Fax: +852 2350 3500

Airbus Hong Kong Representation Office,  
Suite 503, One City gate,  
20 Tat Tung Road, Tung Chung, Lantau  
New territories  
Hong Kong SAR

### Moscow, Russia

Phone: +7 499 929 79 17  
Fax: +7 499 929 79 71

Airbus Moscow Office  
40/2, Bolshaya  
Ordynka Str. 5-th floor  
119017 Moscow  
Russia

### Washington, USA

Phone: +1 703 834 3457

Airbus Americas  
2550 Wasser Terrace  
Suite 9100  
USA  
Herndon, VA 20171



## AIRBUS

AIRBUS S.A.S. 31707 Blagnac Cedex, France  
© AIRBUS S.A.S. 2019 - All rights reserved. Airbus, its  
logo and the product names are registered trademarks.  
Concept Design by Airbus Multi Media Support 2018/1180.  
Photos by Airbus, S. Ramadier, A. Tchakovski,  
J.V. Reymondou, H. Gousse, F. Lancelot.  
Computer renderings by ACJ and Paxion.

Printed in France by Art & Caractère. November 2018.  
Reference: D16011039 Issue 2.

Confidential and proprietary document. This document  
and all information contained herein is the sole property  
of AIRBUS S.A.S. No intellectual property rights are  
granted by the delivery of this document or the disclosure  
of its content. This document shall not be reproduced  
or disclosed to a third party without the express written  
consent of AIRBUS S.A.S.

This document and its content shall not be used  
for any purpose other than that for which it is supplied.  
The statements made herein do not constitute an offer.  
They are based on the mentioned assumptions  
and are expressed in good faith. Where the supporting  
grounds for these statements are not shown, AIRBUS  
S.A.S. will be pleased to explain the basis thereof.

This paper is produced in factories that are accredited  
EMAS and certified ISO 9001-14001, PEFC<sup>®</sup> and  
FSC<sup>®</sup> CoC. It is produced using pulp that has been  
whitened without either chlorine or acid. The paper is  
entirely recyclable and is produced from trees grown in  
sustainable forest resources.

The printing inks use organic pigments or minerals. There  
is no use of toxic dyes or dangerous metals from the  
cadmium, lead, mercury or hexavalent chromium group.

The printer, Art & Caractère (France 81500),  
is engaged in a waste management and recycling  
programme for all resulting by-products.





